



ZODIAC

*The pleasure of **soft**
pure water
in less than **10 minutes***



Ei[®]

Swimming pool
Express salt water chlorinator





The pleasure of *soft pure water*
in less than *10 minutes*

Express salt water chlorinator

- Disinfectant produced directly by the **Ei**[®] cell
- Optimal disinfection even when you're away
- Quick and easy installation by the user
- Cell installed horizontally or vertically

Ei[®] can be installed in less than 10 minutes using the *Quick Fix* NO PLUMBING system.

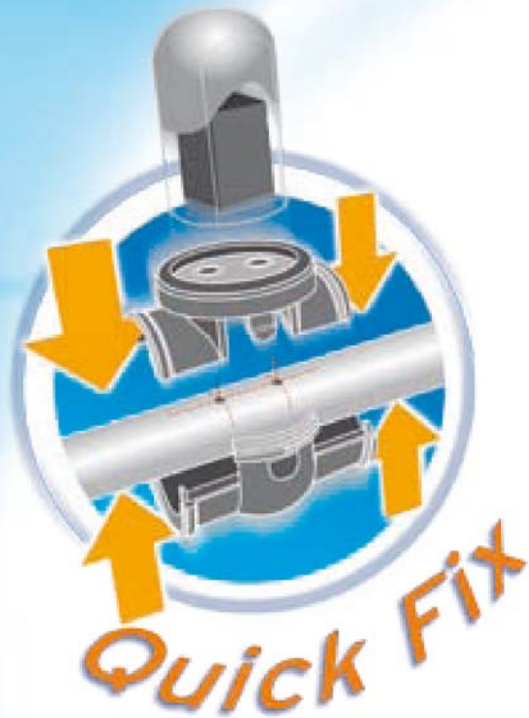

Drill 2, Ø 20 mm holes in the filtration pipe work

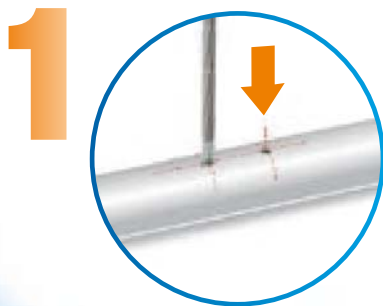

Clip the supporting collar on to the pipe work

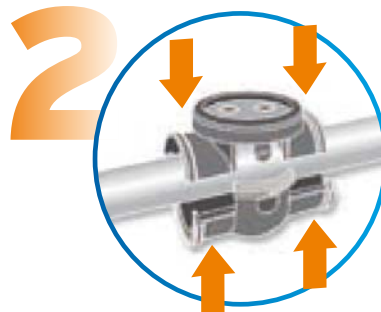

Position the cell and tighten the collars



2 installation possibilities



Horizontal cell installation

or



Vertical cell installation



SAFE SYSTEM

The cell has a flow **detector**



NO MAINTENANCE

Self-cleaning electrodes using **adjustable** polarity inversion



RELIABILITY

- **Titanium Clearwater® technology electrodes** guarantee an optimal life span
 - Whatever the cause of deterioration, the control box and the cell will be repaired or replaced during the **24 month period** following your purchase.



EASY TO MONITOR

- User friendly control panel
- **Programmable clock** in order to adjust filtration times and chlorine production independently



For optimal bathing comfort!

Add the pH controller "**pH Perfect**" to your **Ei®** salt water chlorinator.



Ei®, HOW DOES IT WORK?

Salt Water Chlorination is simple.

The pool water is very slightly salty:

4 g/l (9 times less than sea water).

- The salt water chlorinator is installed on the pool's filtration system.

The salt is converted to chlorine, a powerful disinfectant, by the cell and **immediately dissolved in the water**.

- The chlorine produced is used to fight against bacteria, algae and micro-organisms.
- The chlorine that is eliminated by the UV effects of sunlight is permanently renewed by the cell **without any further intervention**.

Ei® is adapted to all types of swimming pools and pool surfaces, for use on existing pools and pool's with small technical facilities.

3 AVAILABLE MODELS:

	Ei® 10	Ei® 17	Ei® 25
Chlorine production	10 g/h	17 g/h	25 g/h
Water volume (calculated volume for 8h of filtration)	40 m ³	70 m ³	100 m ³

TECHNICAL CHARACTERISTICS:

- Power supply: 220-240 VAC (50 Hz)
- Minimum flow: 5 m³/h
- Maximum flow: over 18 m³/h, the processing cell must be installed on a by-pass
- Maximum authorized cell pressure: 275 kPa = 2,75 bars
- Maximum water temperature: 40°C
- Minimum salt level required: 3 g/l (Recommended rate 4 g/l)
- Optimisation of titanium electrode performances, using an exclusive alloy, in the polarity inversion (every 2h30 or 5h) in hard water areas
- Cell position: cell body vertical or horizontal (with flow detector)
- Cell size (L x H): 162 x 270 mm
- Length of the cable between the cell and the box = 1,8 m
- Protection index = IP 24

