

EXTREME™ pool lining system

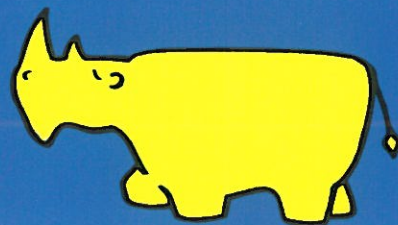

EXTREME: Highest in degree. Greatest. Stringent. Utmost. To the highest limit.



- Suitable for new pools or refurbishment
- Reinforced material 1.5mm thick
- Guaranteed for 10 years up to 90°F
- Hard wearing yet flexible
- Commercial or Domestic



GUARANTEED THE TOUGHEST

Welcome to the the **EXTREME™** pool lining system. The tough, hard wearing PVC material is 1.5mm thick and re-inforced with an internal webbing. This gives it both the strength and durability to withstand the highest expectations of the most heavily used public pools, and the quality of finish to transform any domestic pool.

The adaptability of the system allows installation into absolutely any size or shape of pool. The textured non-slip surface, available in a choice of four colours, will make any steps a safe and attractive feature.

Continual development for over thirty years ensures the maximum resistance to the ageing effect of the water treatment, sunlight and algae.



The material is brought to site and is cut and tailored to match the individual contours of your pool. Panel by panel, the lining is made up and the over-lapped edges fused together using specialised hot-air welding equipment. Once thoroughly tested, the seams are then finished with a liquid PVC.

Secured around the perimeter of the pool floor, the material is not bonded directly to the pool structure. This allows it to absorb any movement in a flexible or cracked shell making it the ideal and risk free choice for new pools or the refurbishment of old leaking concrete and tiled pools.

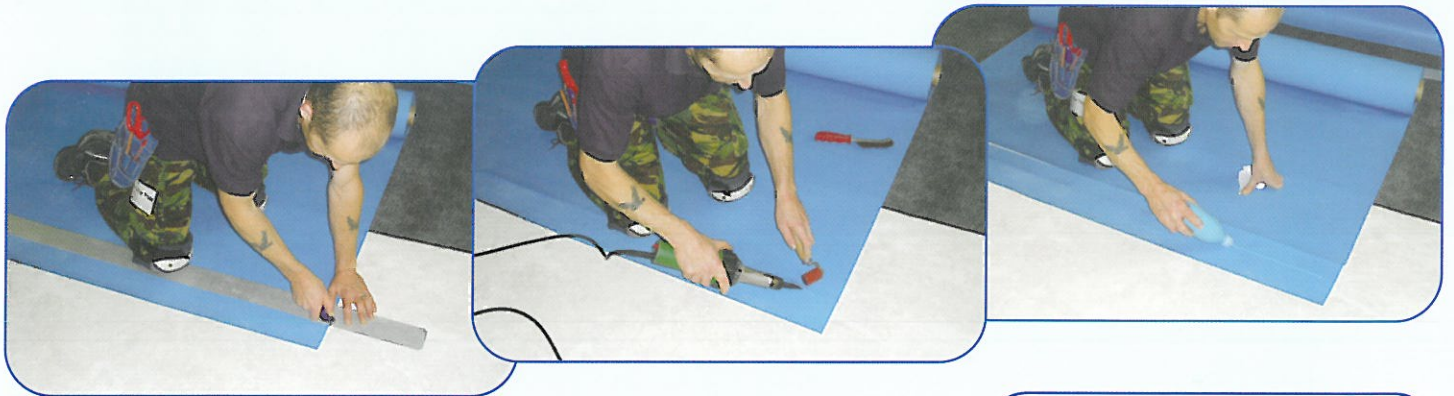

If the Coping stones are to be lifted, a re-usable plastic liner-lock can be installed to support the wall panels, alternatively, a PVC "Profile" plate can be rivetted and sealed at the top of the wall onto which the material is permanently welded allows the coping stones to be left in place.

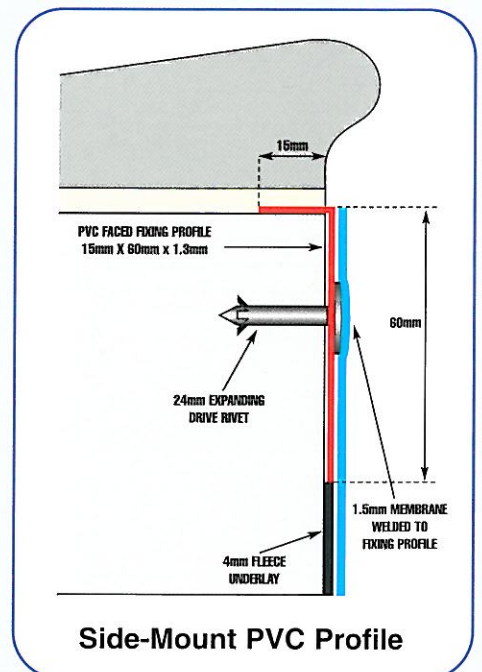
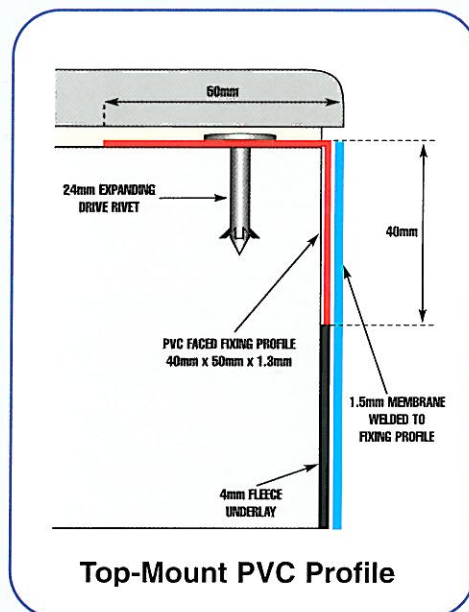



ROSEBERY SCHOOL

Ideal for:

- **Schools • Hotels**
- **Holiday Parks • Health Clubs**
- **Hydrotherapy Pools**
- **Deck Level Pools**
- **Domestic Pools**



- Installed to new or existing Linerlock
- P.V.C. track system - no need to lift coping stones

- Racing Lanes, Motifs, Depth Markers
- Non-slip for Step Treads or Shallow Pools
- 6 Colours, 5 Patterns and 5 Tilebands available



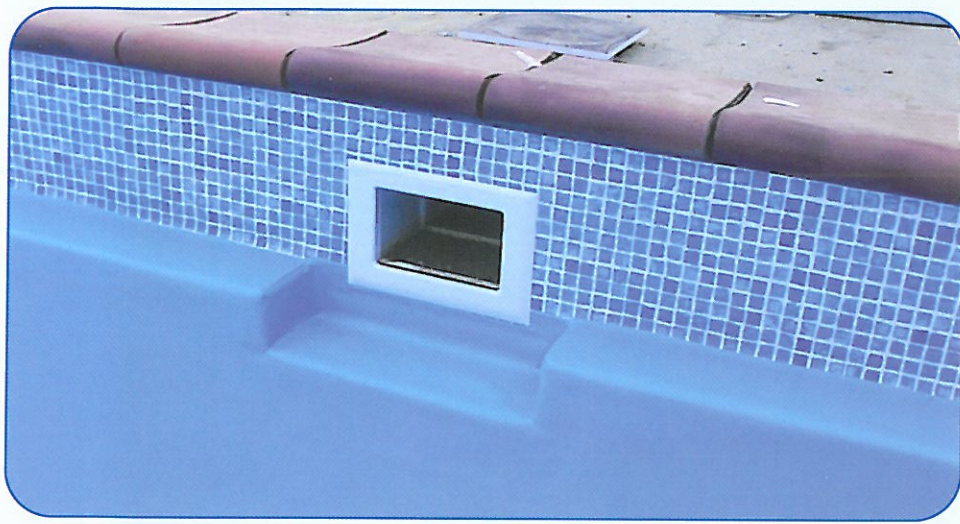

The system can be installed throughout the year.

With no curing or drying times to wait for, the average domestic pool would be re-filling after 3 days. Your pool can be totally transformed and back in use in a very short time.

No longer will you have to worry about water loss, cracks, or endless repainting.

Unaffected by frost and ice, the material will tolerate the most extreme weather conditions.

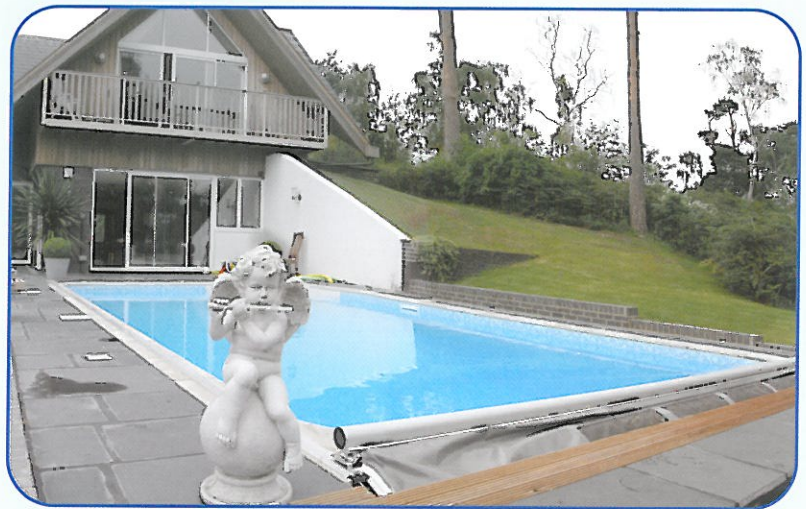

6 plain colours, 5 patterns and 5 decorative tilebands available

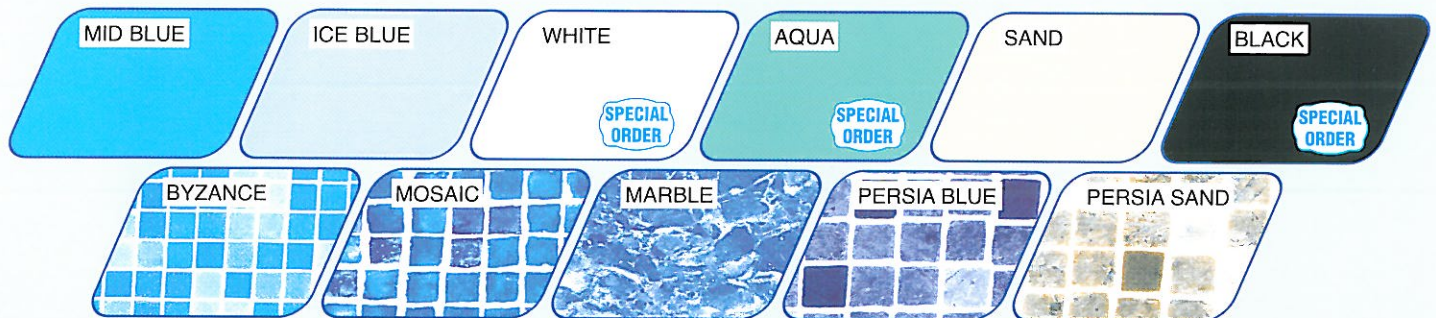

The water-proofing of the membrane and the welded seams are guaranteed Pro-rata for 10 years for pools run up to 32° C, (90° F), and 5 years for Hydrotherapy use up to 35° C, (95°F).

 **Plastica**

Available from:

WWW.PLASTICAPOOLS.COM